

THIS DRAWING IS THE PROPERTY OF ENGINEERING & FACILITIES CONSULTING, INC. AND MAY NOT BE ALTERED, REPRODUCED, DISTRIBUTED AND/OR UTILIZED WITHOUT WRITTEN AUTHORIZATION.

22 Oct 2017 4:39PM CIV02
P:\MVA Projects\Catholic Church Projects\Christ the Good Shepherd\Christ the Good Shepherd\Drawings\UGS-SHEET 14 DRAINAGE AREA MAP OFFSITE DRAINAGE FLOW.dwg

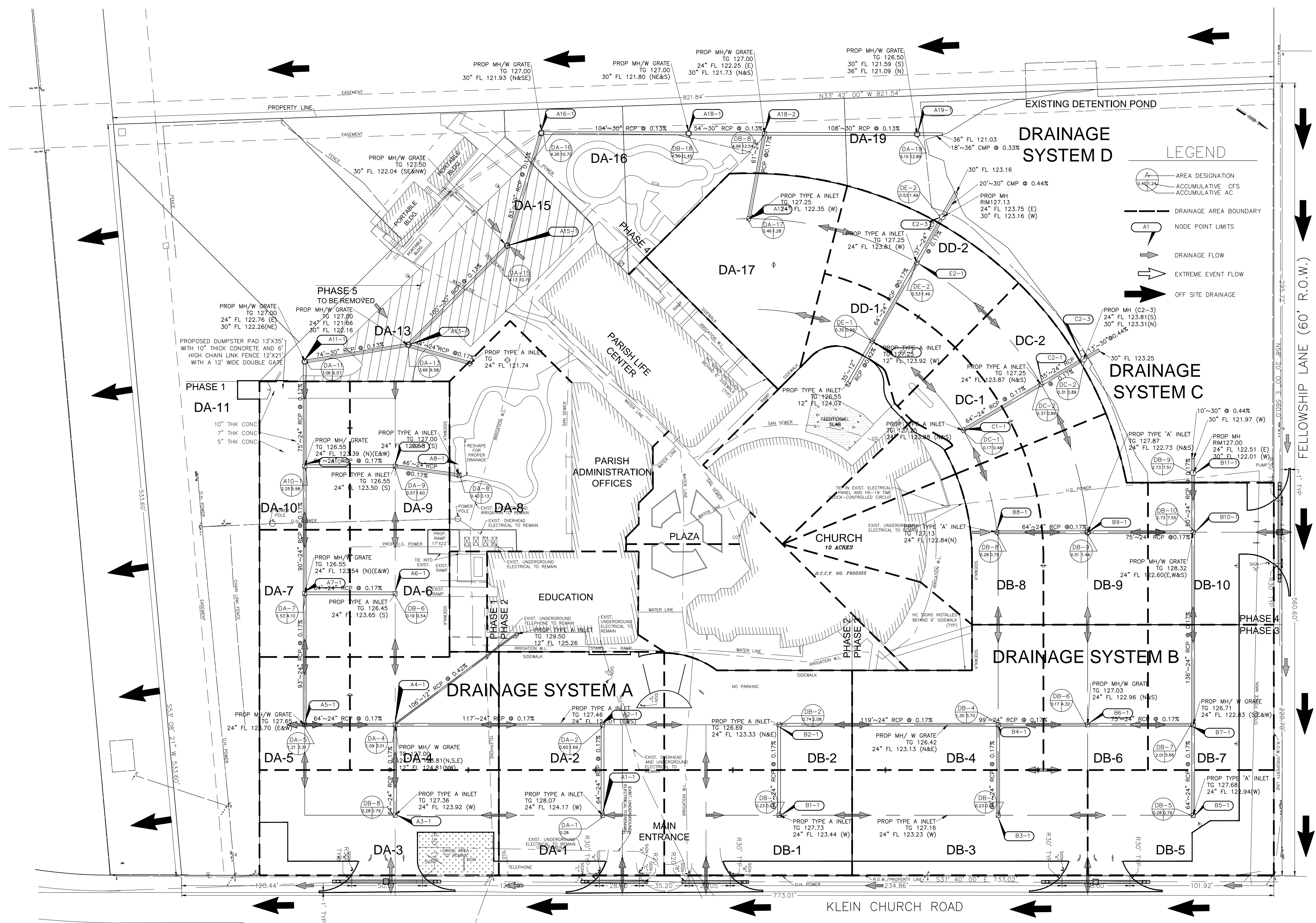

PROJECT:
Proposed Pavement Replacement
Christ the Good Shepherd
18511 Klein Church Road
Spring, Texas 77379

OWNER:
Christ the Good Shepherd
Archdiocese of Galveston-Houston
18511 Klein Church Road
Spring, Texas 77379
Rev. James Burkart, Pastor

ENGINEER:
Engineering & Facilities Consulting, Inc.
Firm Registration No. F-003940
8203 Willow Place Dr. South, Suite 405 - Houston, TX 77070
Ph: 281-894-2001; Fax: 281-894-2004
Contact: Richard H. Ghanem, PE, President
e-Mail: r.ghanem@efctx.com - Website: www.efctx.com

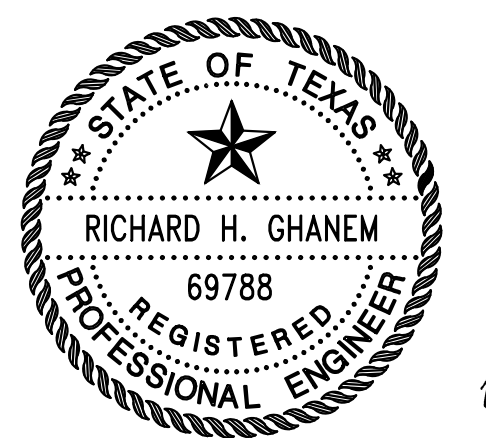

10/22/17
Richard Ghanem

NO.	REVISIONS	DATE	NAME

LEGEND

	PROPOSED 5" CONCRETE PAVEMENT (PARKING SPACES AND SIDEWALKS)
	PROPOSED 7" CONCRETE PAVEMENT (DRIVE THRU AREAS AND DRIVEWAYS)
	PROPOSED 10" CONCRETE PAVEMENT (DUMPSTER PAD)
	PROPOSED WHEELSTOP
	PROPOSED 6" CURB
	PROPOSED MODIFIED MANHOLE
	PROPOSED MANHOLE
	PROPOSED STORM TYPE A INLET
	PROPOSED S1 LIGHT
	PROPOSED S2 LIGHT
	PROPOSED LIGHT WITH RECEPTACLE
UNDER GROUND UTILITY	
	UG ELECTRICAL
	UG IRRIGATION
	UG SANITARY
	UG STORM
	UG TELEPHONE
	UG WATER
	ELECTRICAL LIGHTING
	OVER HEAD POWER
	UG 6" PVC PIPE

**DRAINAGE AREA MAP
OFFSITE DRAINAGE FLOW**

SURVEYOR:	DESIGNED BY: LG
SCALE: 1"=40'	DRAWN BY: LG
DATE: 10/22/17	CHECKED BY: RHG
EFC PN: CIV-389-15	SHEET NO: C 14 OF 38