

PLAN & PROFILE
FOR PROP. 15" STORM RCP

SCALE: V: 1"=20'-0"
H: 1"=2'-0"

THIS APPROVAL IS FOR CONSTRUCTION UTILIZING AUCER/BORE AND JACK METHOD ONLY. FOR ANY REASON, IF OPEN CUT METHOD IS REQUIRED, APPROPRIATE PAVEMENT RESTORATION TYPICAL SHEET SHALL BE SUBMITTED FOR REVIEW AT LEAST 48 HOURS IN ADVANCE BEFORE STARTING CONSTRUCTION. THESE RESTORATIONS TYPICAL SHALL BE DRAWN ON MYLAR, SEALED, SIGNED AND DATED BY A PROFESSIONAL ENGINEER IN THE STATE OF TEXAS.

CONTRACTOR TO PROBE ALL UNDERGROUND UTILITIES BETWEEN R.O.W. AND VERIFY CLEARANCE PRIOR TO BORE & JACK OPERATION.

SEE C.O.H. DWG NO. 02447-01 FOR BORING & BACKFILL.

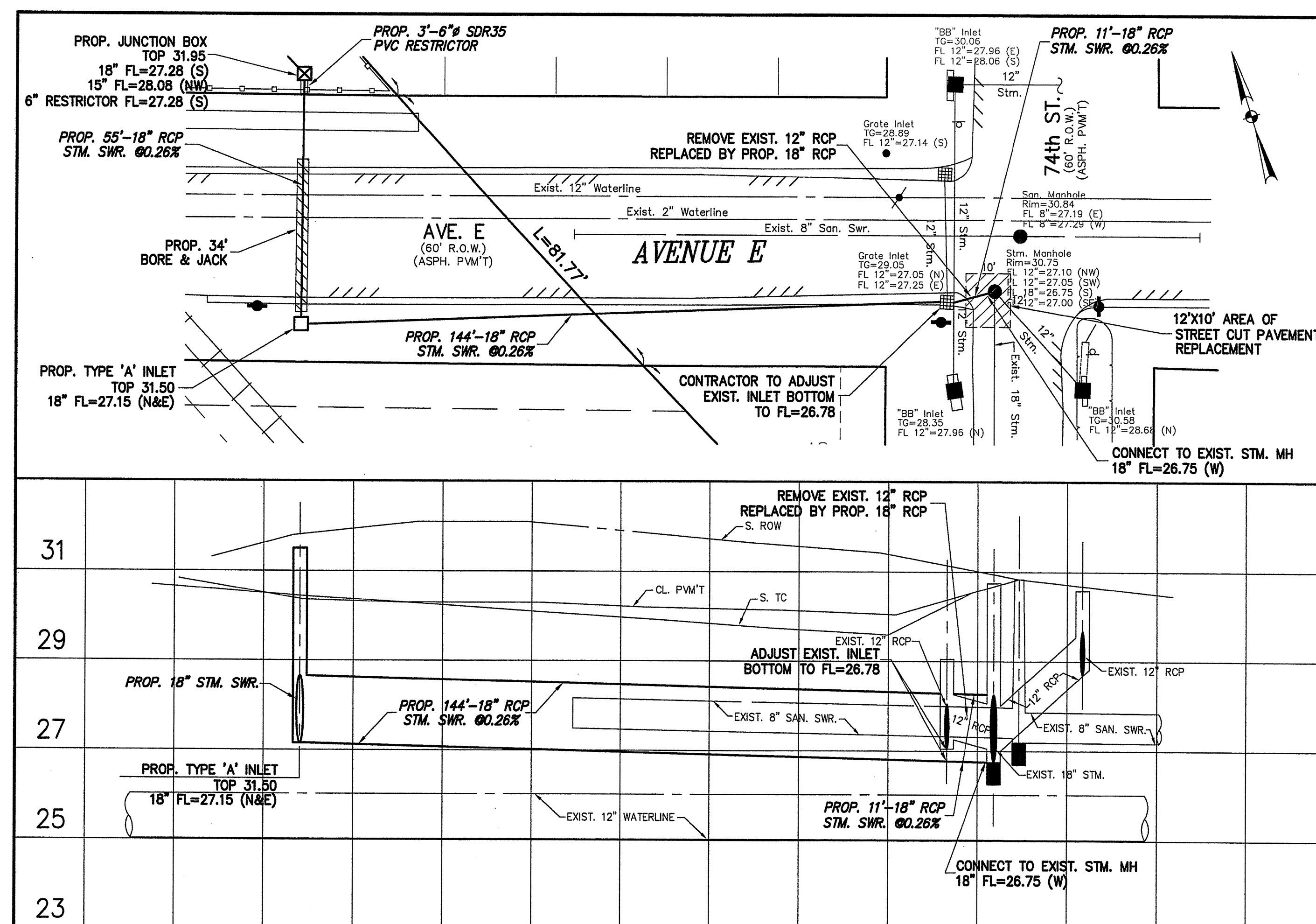

PLAN & PROFILE
FOR PROP. 18" STORM RCP

SCALE: V: 1"=20'-0"
H: 1"=2'-0"

TO ARRANGE FOR LINES TO BE TURNED OFF OR MOVED, CALL CENTERPOINT AT 713-207-7777.

NOTICE:

AT LEAST 48 HOURS BEFORE EXCAVATING IN STREET R.O.W. OR EASEMENTS CALL THE LONE STAR NOTIFICATION 713-223-4567

PRIVATE UTILITY LINES SHOWN

DATE: _____
CENTERPOINT ENERGY/ELECTRIC FACILITIES
(APPROVED ONLY FOR CROSSING UNDERGROUND DUCTILES UNLESS OTHERWISE NOTED.) VALID AT TIME OF REVIEW ONLY.

DATE: _____
SBC Approved for underground conduit facilities only. SIGNATURE VALID FOR ONE YEAR.

DATE: _____
CENTERPOINT ENERGY/GAS FACILITIES
(GAS SERVICE LINES ARE NOT SHOWN)

RENEngineering, Inc.
Consulting Engineers
6100 Corporate Dr., Suite 515, Houston, TX 77036
Tel: 713-981-0041 • Fax: 713-981-1156

PROJ: 08020 / REN SCALE: 1" = 20'-0" DATE: 4/30/2007

John P. McGovern, M.D. Community Sports & Recreation Building
7318 AVENUE F, Houston, TX 77011

PLAN AND PROFILE

NOTE: CITY SIGNATURES VALID FOR ONE YEAR ONLY AFTER DATE OF SIGNATURES

CITY OF HOUSTON
DEPARTMENT OF PUBLIC WORKS AND ENGINEERING

WATER	STREET & BRIDGE
WASTEWATER	TRAFFIC
STORM	STORM WATER QUALITY
FACILITIES	

FILE NO: _____ FOR CITY OF HOUSTON USE ONLY

DRAWING SCALE:
HORZ: 1"=20'-0"
VERT: 1"=2'-0"

SHEET No. 6 OF 10



C6.0

ILMS No.
LOG No. 2007-