

ARCHITECTURE
HISTORIC PRESERVATION
HISTORICAL INTERIORS

1105 West 42nd Street
Austin, Texas 78756
(T) 512.476.0433
(F) 512.476.2198

BRAZORIA COUNTY HISTORICAL MUSEUM
EXTERIOR RESTORATION AND REPAIR
ANGLETON, TEXAS

PROJECT NO: 010-10

DATE: 06/15/11

REV:

SHEET NAME:
DETAILS

SHEET NO:

A-401

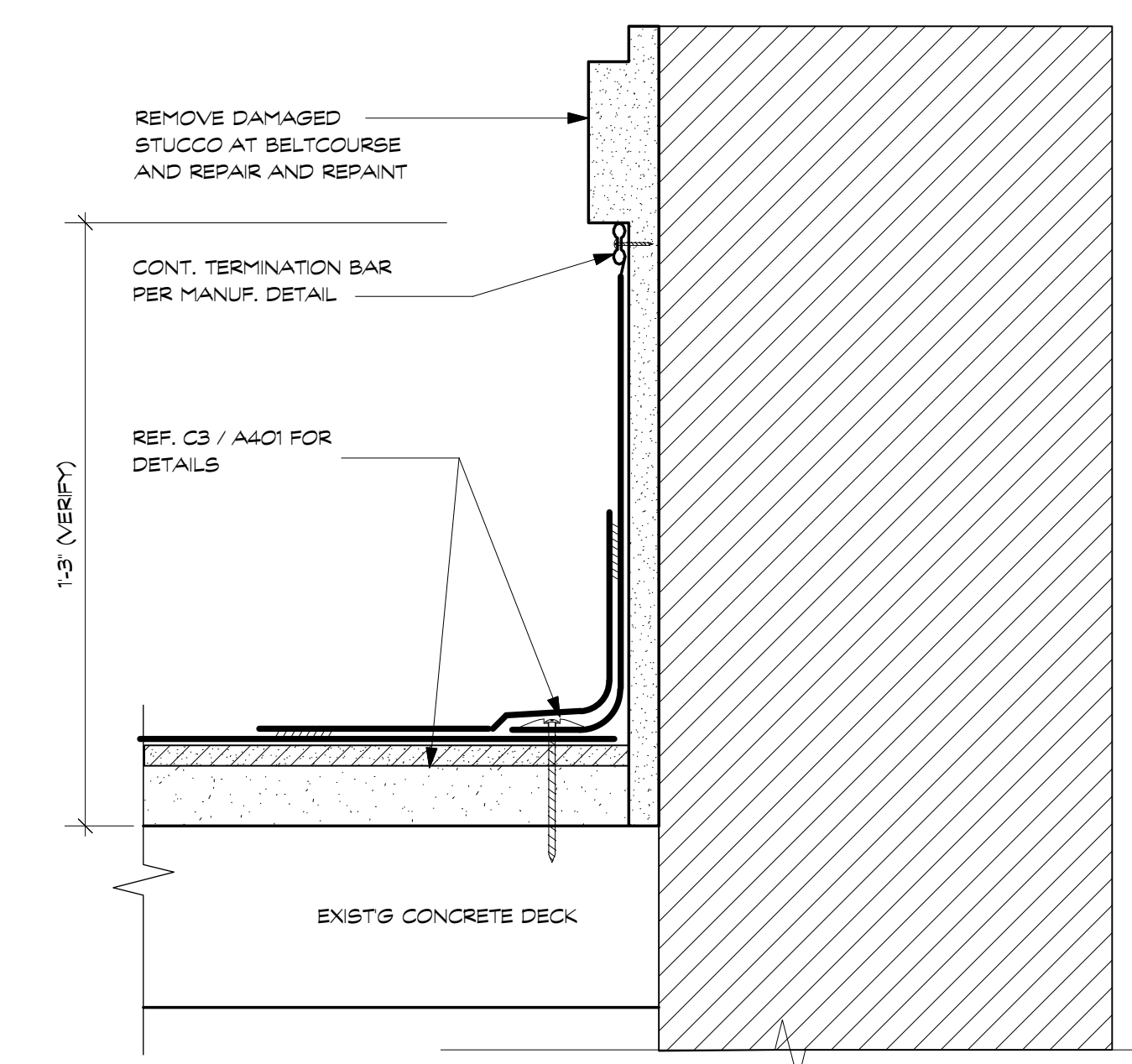

C4 MECH ROOF AT EXTERIOR WALL
SCALE: 3" = 1'-0" (BID ALTERNATE)

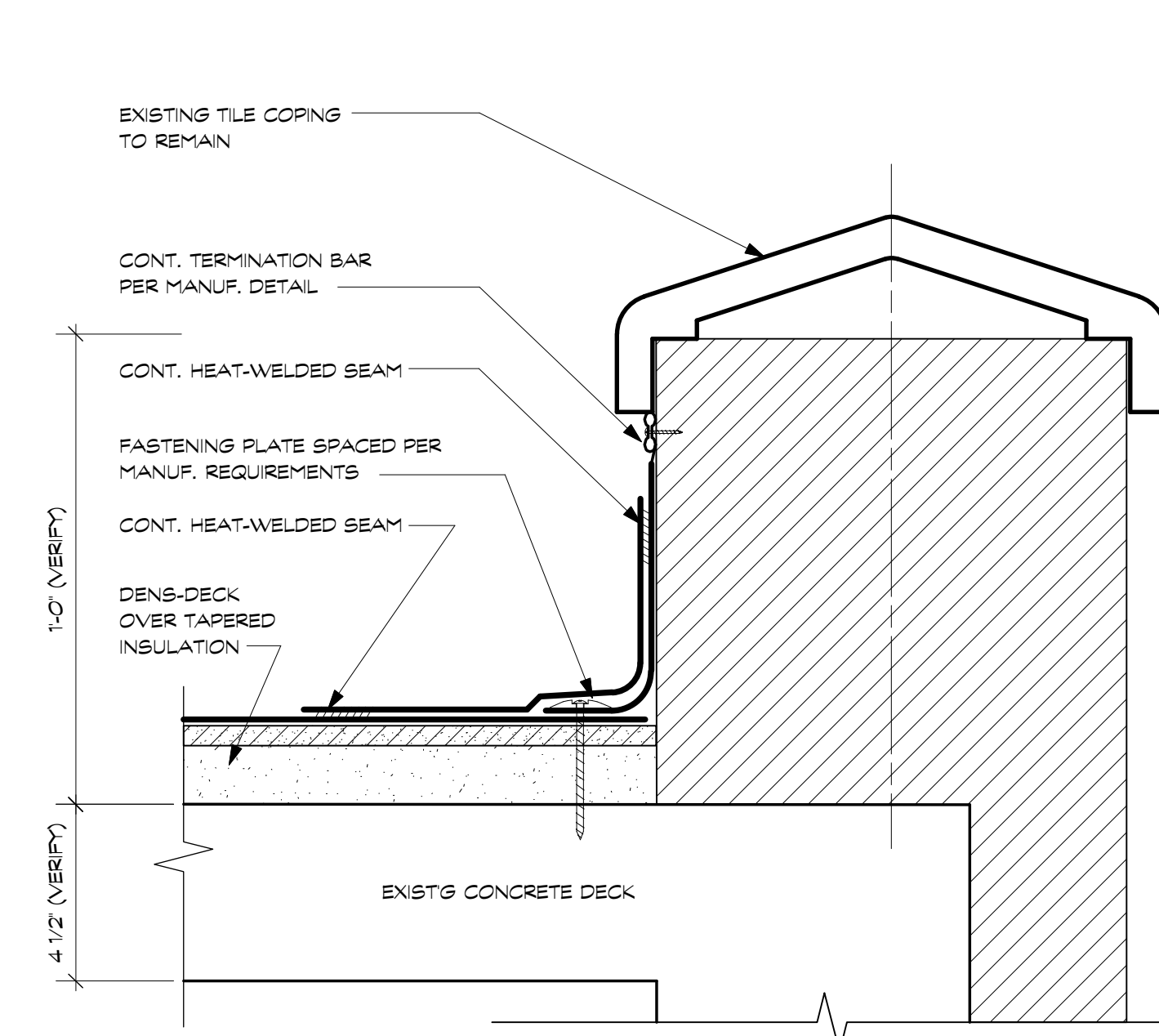

C3 MECH. ROOF AT PARAPET
SCALE: 3" = 1'-0" (BID ALTERNATE)

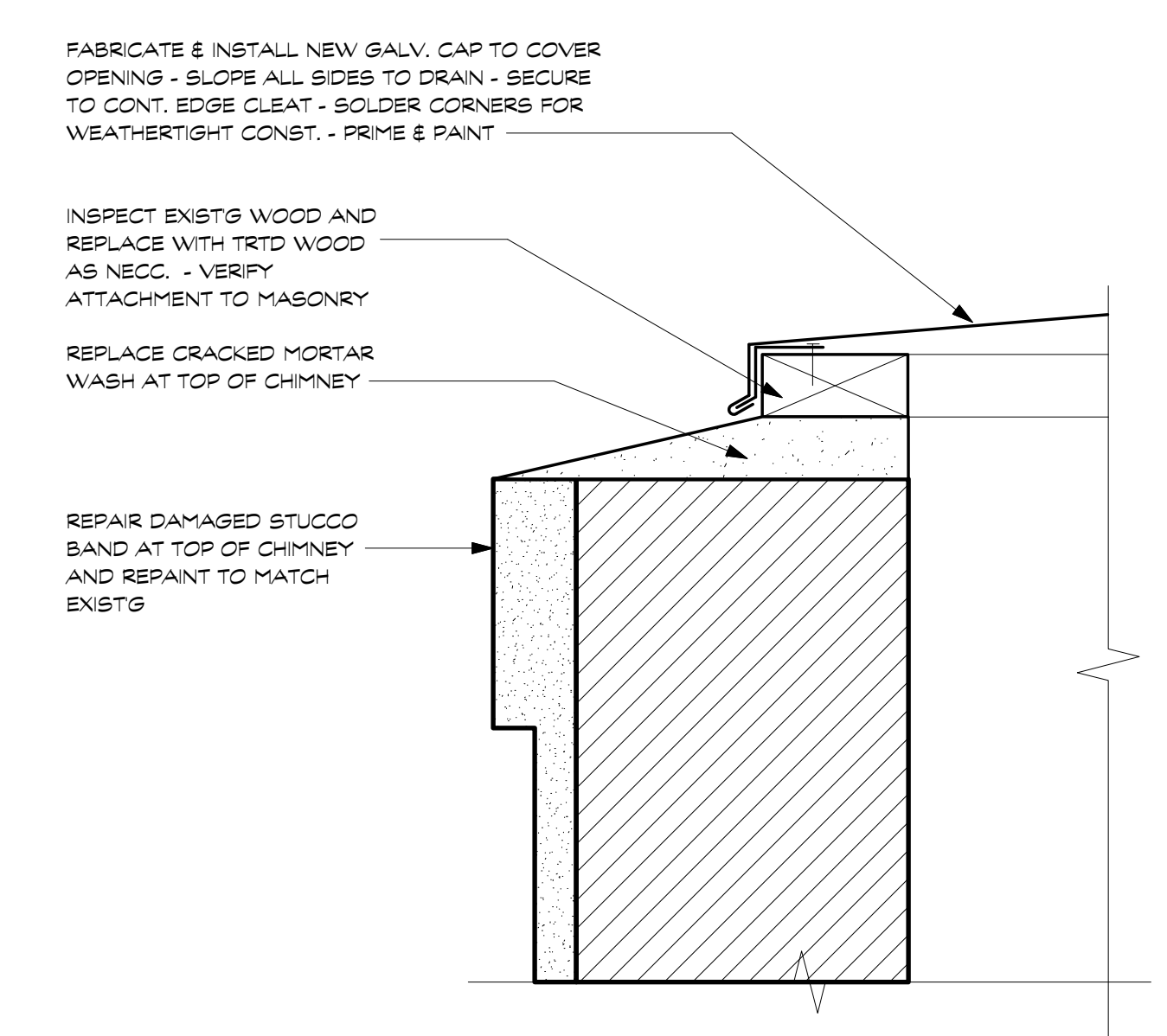

B4 CHIMNEY CAP
SCALE: 3" = 1'-0"

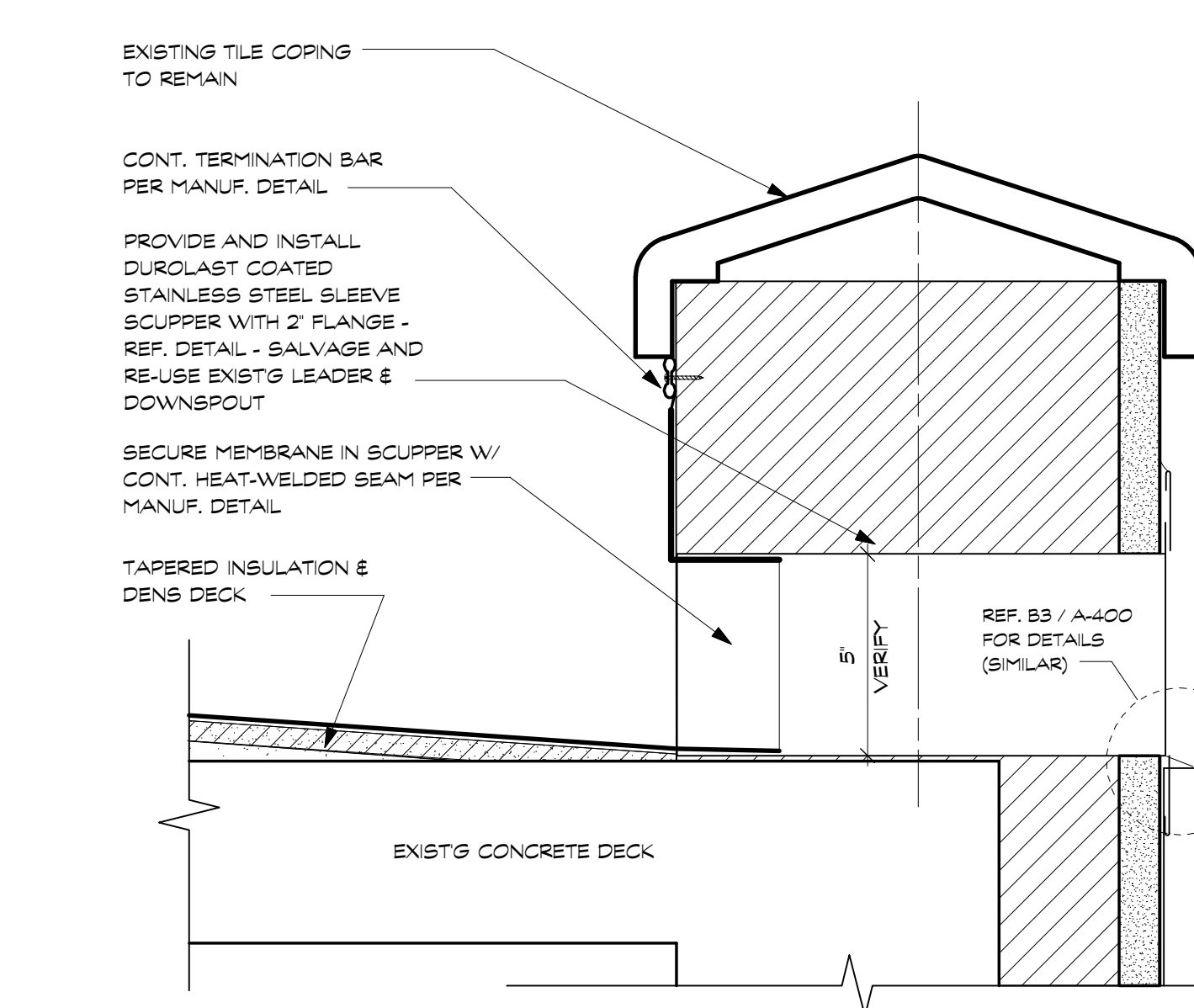

B3 SCUPPER / LEADER CONNECTION
SCALE: 3" = 1'-0" (BID ALTERNATE)

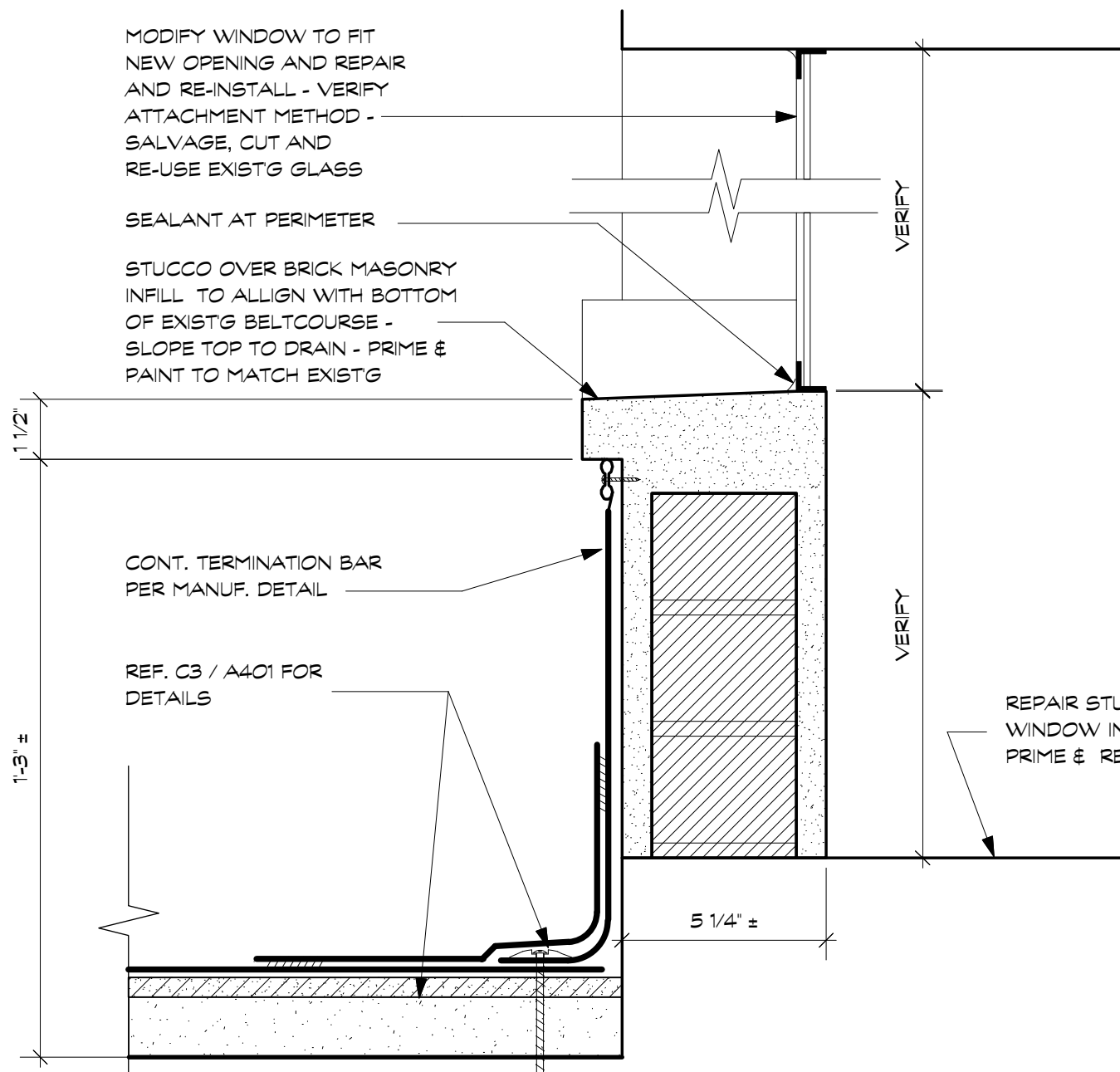

A4 SECTION AT WDW INFILL
SCALE: 3" = 1'-0" (BID ALTERNATE)

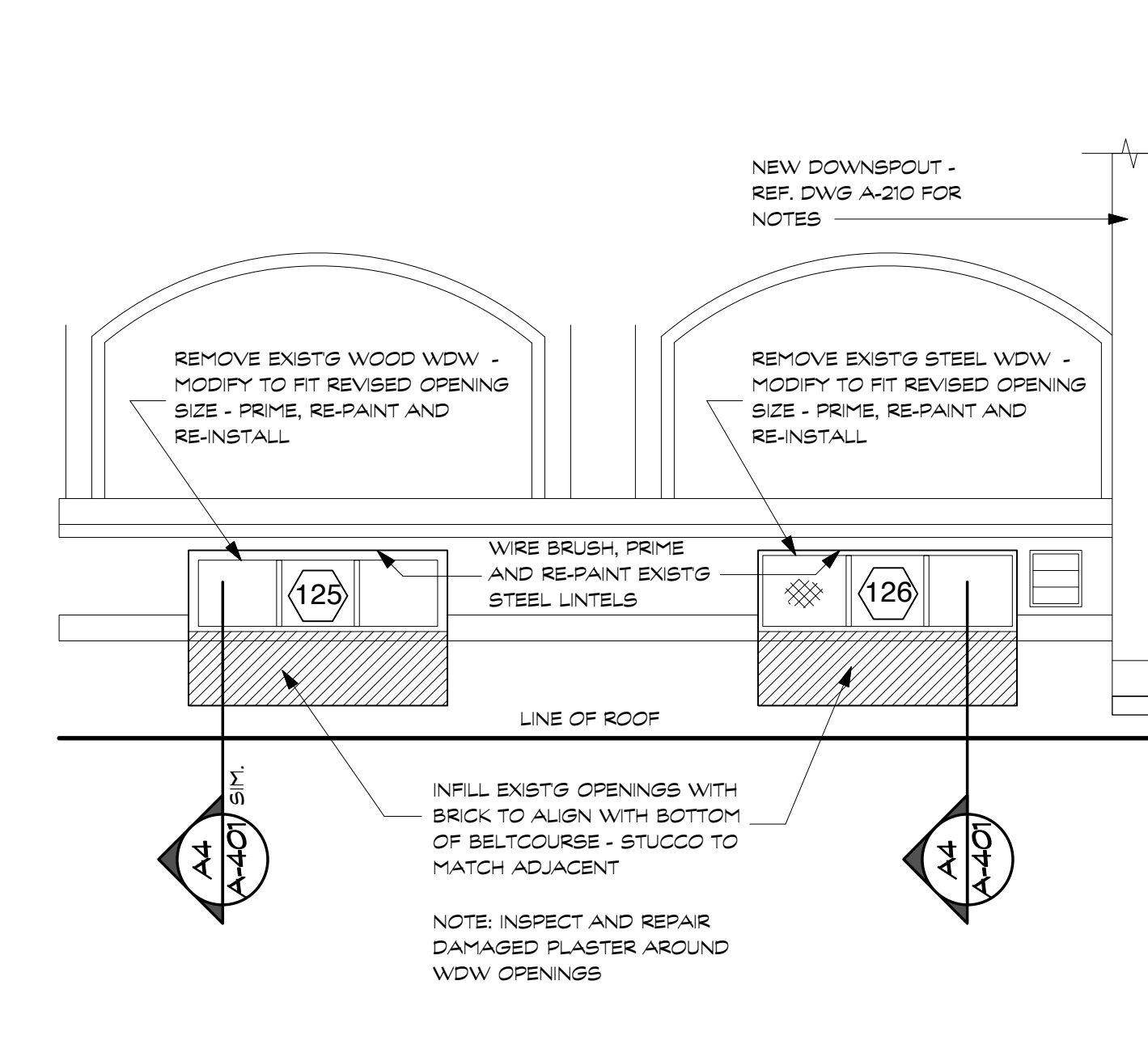

A3 ELEVATION AT MECH BLDG ROOF
SCALE: 1/2" = 1'-0" (BID ALTERNATE)

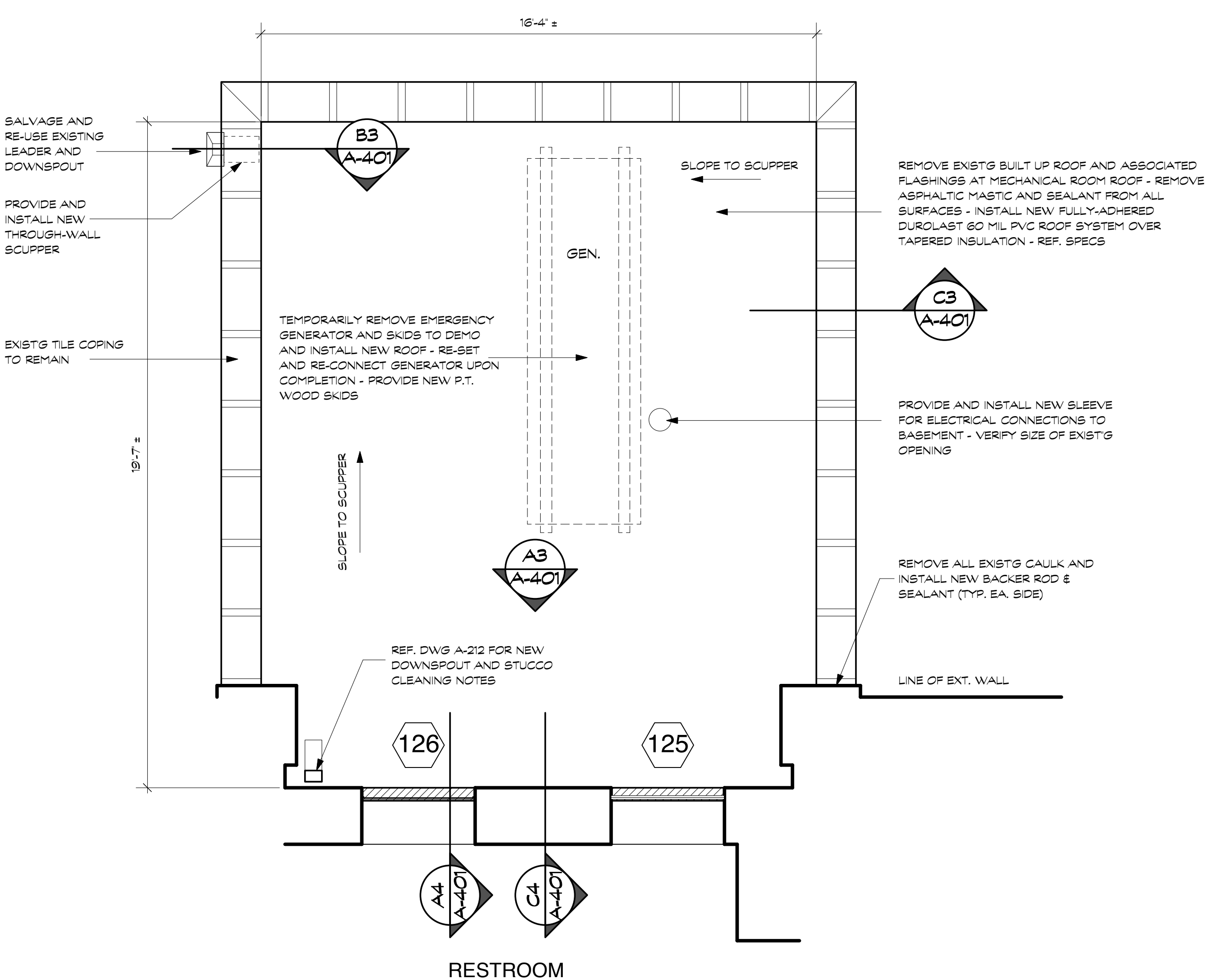

B2 ENLARGED PLAN OF MECHANICAL ROOM ROOF - (BID ALTERNATE)
SCALE: 3/8" = 1'-0"

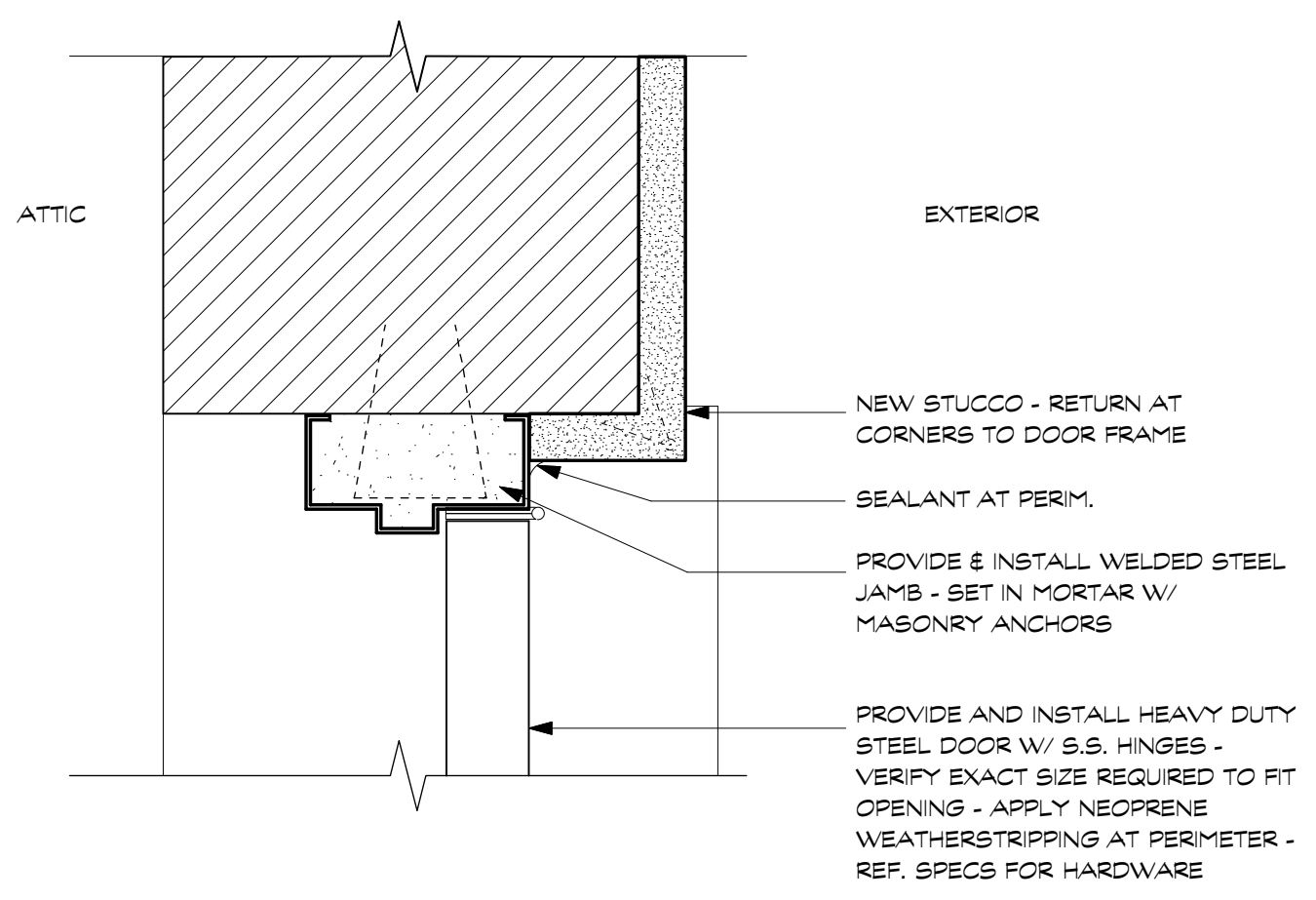

A1 JAMB AT ATTIC ACCESS DOOR
SCALE: 3" = 1'-0"

A2 NOT USED
SCALE: NTS