

ROOF GENERAL NOTES

- A)** BUILDING TO REMAIN WATERTIGHT AT ALL TIMES. CONTRACTOR TO PROVIDE AND INSTALL TEMPORARY COVERING AS NECESSARY TO PREVENT WATER PENETRATION DURING ROOF WORK.
- B)** NEW LEADERS AND DOWNSPOUTS TO BE FLOOD TESTED UPON COMPLETION. REFER TO SPECIFICATIONS FOR DETAILS.
- C)** EXISTING PVC ROOF TO REMAIN. MEMBRANE TO BE PULLED AWAY FROM WALLS AS NECESSARY TO PERFORM STUCCO REPAIRS. RE-SECURE MEMBRANE UPON COMPLETION.
- D)** COORDINATE ROOF WORK WITH DURALAST TO ENSURE EXISTING ROOF WARRANTY IS MAINTAINED. PROVIDE APPROPRIATE DOCUMENTATION FROM DURALAST TO CERTIFY.
- E)** BID ALTERNATE: REMOVE EXISTING BUILT-UP ROOF AT ONE STORY MECHANICAL ROOF ADDITION AND INSTALL NEW PVC ROOF SYSTEM. REMOVE AND REINSTALL GENERATOR TO PERFORM WORK. REFER TO SPECIFICATIONS AND DETAILS.
- F)** INSPECT ENTIRE PERIMETER OF PVC ROOF AT PARAPET AND REMOVE ANY DETERIORATED SEALANT AND RESEAL. ASSUME 20% REPLACEMENT FOR BIDDING.

ROOF KEYNOTES

- 01** REMOVE TERMINATION BAR & PULL BACK ROOF MEMBRANE TO INSTALL NEW SCUPPER AND DOWNSPOUT. INSPECT ADJACENT WOOD DECKING AND REPAIR UNDER ALLOWANCE. RE-SECURE ROOF MEMBRANE AFTER SCUPPER INSTALLATION.
- 02** REMOVE ALL STUCCO FROM PARAPET - REPAIR DAMAGED/CRACKED BRICK UNDER ALLOWANCE - REPOINT WALL AND RE-STUCCO - COORDINATE WITH SCUPPER INSTALLATION. PRIME AND PAINT WALL PER NOTES.
- 03** EXISTING HATCH TO REMAIN. PRIME AND PAINT HATCH LID UPON COMPLETION.
- 04** MAINTAIN AND PROTECT EXISTING A/C CONDENSER DURING CONSTRUCTION. PROVIDE AND INSTALL NEW INSULATION AT REFRIGERANT LINES UPON COMPLETION.
- 05** PROVIDE AND INSTALL NEW SCUPPER, LEADER & DOWNSPOUT AS DETAILED.
- 06** PROVIDE AND INSTALL NEW ROOF WALKWAY PADS BETWEEN HATCH AND ATTIC ACCESS DOOR.
- 07** PROTECT EXISTING SKYLIGHT DURING WORK.



1105 West 42nd Street
Austin, Texas 78756
(T) 512.476.0433
(F) 512.476.2198

BRAZORIA COUNTY HISTORICAL MUSEUM
EXTERIOR RESTORATION AND REPAIR
ANGLETON, TEXAS

PROJECT NO: 010-10
DATE: 06/15/11
REV:
SHEET NAME:
ROOF PLAN
SHEET NO:

A-123

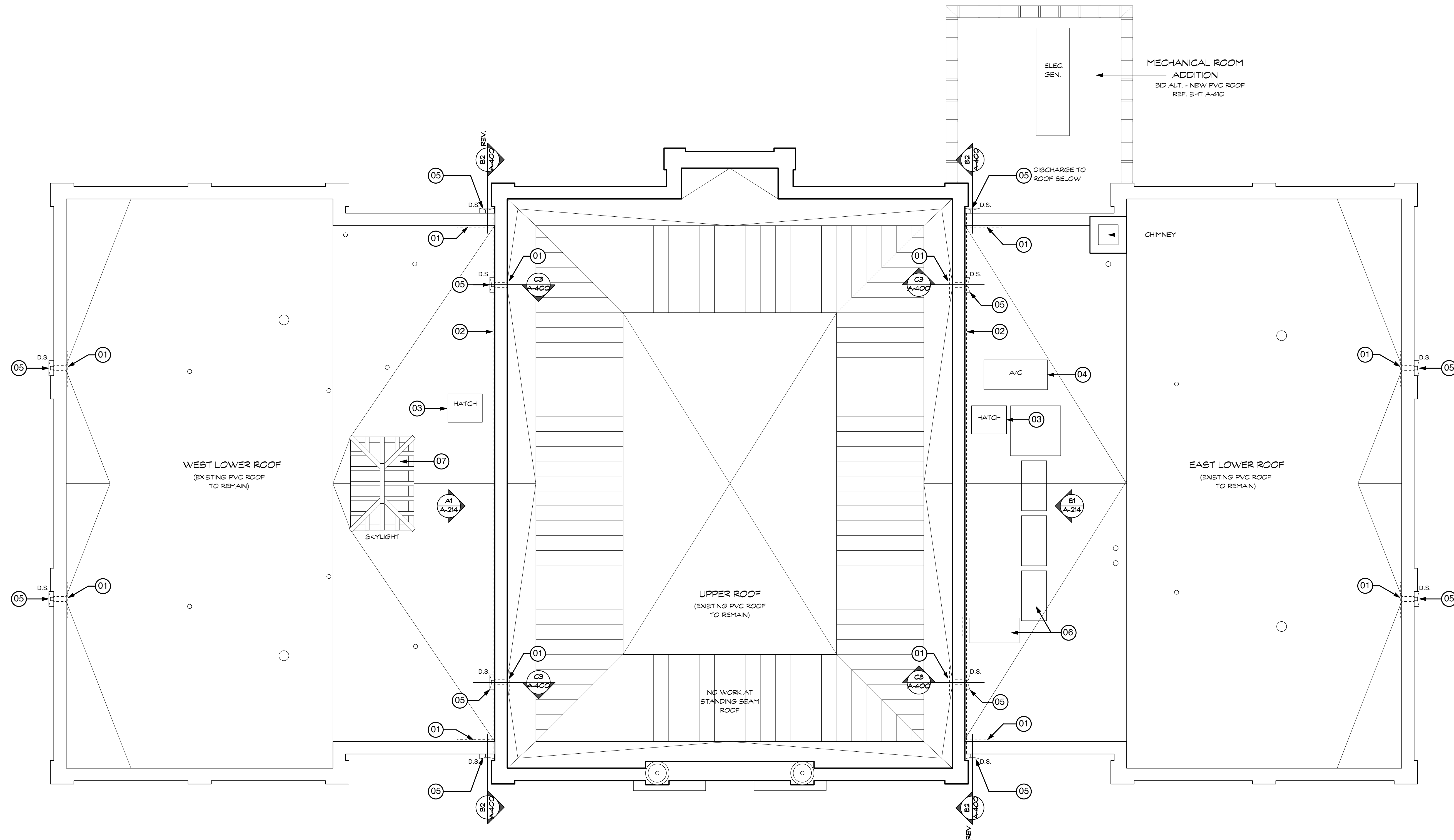

1 ROOF PLAN
SCALE: 3/16" = 1'-0"

