

Issue	Date	Description
100% CD	12/15/11	Bld Set
Red Line	11/08/11	
<b>Review</b>	<b>10/21/11</b>	

Project Number:	10007
CAD Drawing File:	CAD Drawing File
Drawn By:	JS
Checked By:	TS
Copyright:	©Morningside Architects LLP 2010

Sheet Title  
**First Floor Demo Plan**

Sheet Number

**A1.0**

## DEMOLITION LEGEND & KEYED NOTES

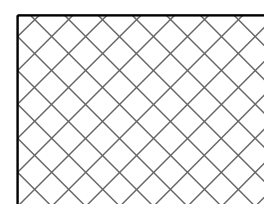

1. DEMOLISH: EXISTING INTERIOR WALLS, PORTIONS OF EXTERIOR WALLS, WHERE NOTED FOR NEW FLOORS - FLOOR FINISHES, CEILINGS, PLUMBING FIXTURES AND PIPES, ELECTRICAL EQUIPMENT, LIGHT FIXTURES, WIRE AND CONDUIT, MECHANICAL EQUIPMENT AND DUCTWORK. PROTECT ALL STRUCTURAL COLUMNS AND BEAMS U.N.O., SECURE AND SUPPORT REMAINING STRUCTURE AS REQUIRED.



2. REMOVE WALLS, WINDOWS, LOUVERS, ITEMS SHOWN DASHED AS REQUIRED FOR NEW WORK.

3. PROTECT ADJACENT SIDEWALKS, LANDSCAPING, EXISTING EXTERIOR WALLS TO REMAIN AND EXISTING STRUCTURAL MEMBERS.

4. SALVAGE EXISTING STOREFRONT WINDOWS/DOORS TO RE-USED IF FEASIBLE, GENERAL CONTRACTOR TO VERIFY.

5. AT AREAS OF EXTERIOR WALLS WHERE HOSE BIBS ARE TO BE REMOVED, PATCH WITH MATCHING BRICK OR GROUT AS REQUIRED.

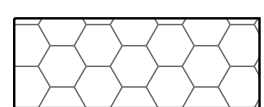

6. DEMOLISH: EXISTING HOUSE KEEPING SLABS AND CURBS DOWN TO FINISH FLOOR ELEVATION.

7. DEMOLISH: ABANDONED PLUMBING PIPES, BRACKETS, AND VENT PIPING, ELECTRICAL EQUIPMENT, WIRE AND CONDUIT, MECHANICAL EQUIPMENT AND DUCTWORK UNLESS OTHERWISE NOTED ON MEP DRAWINGS.

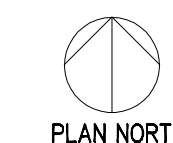
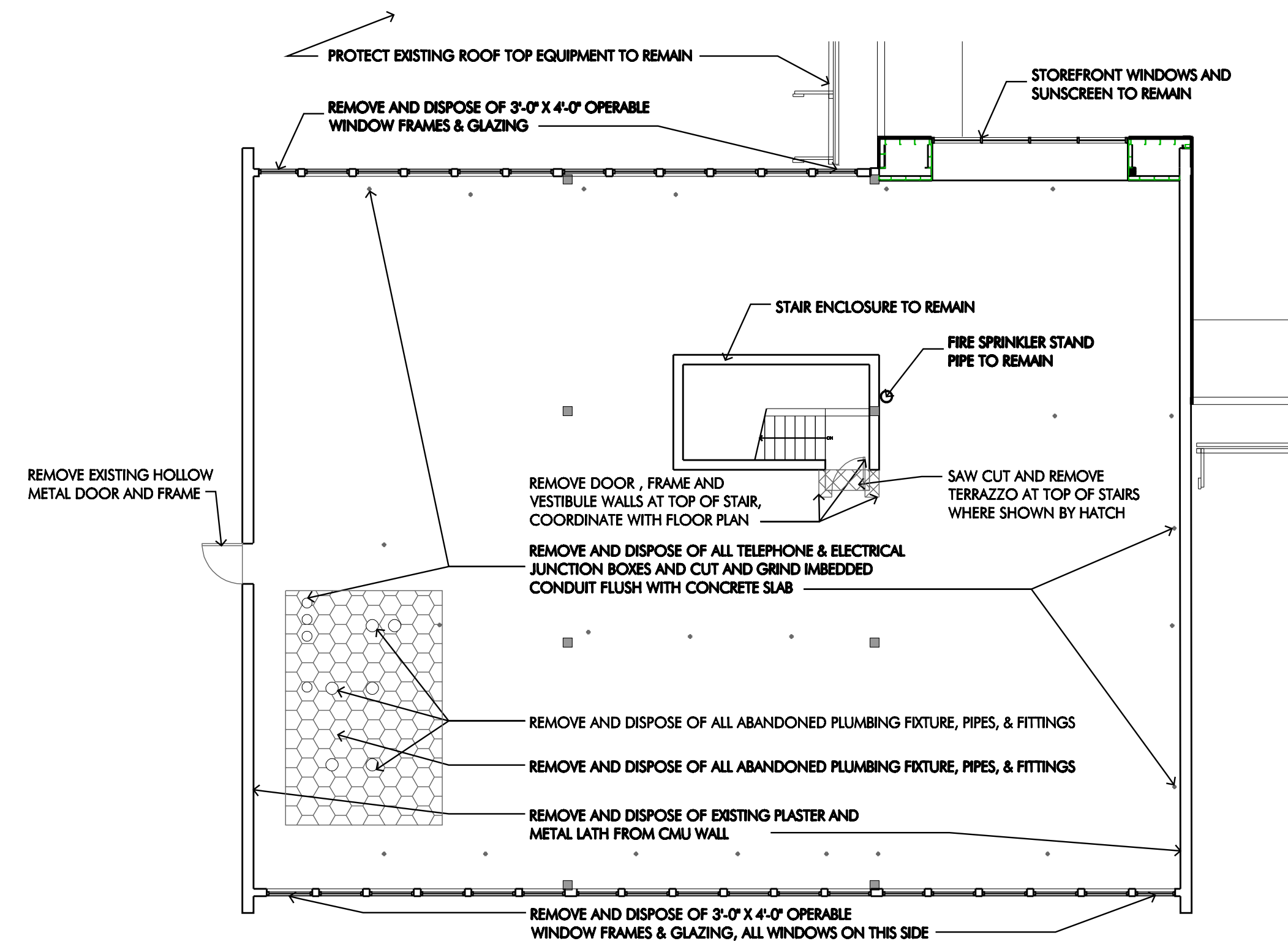

**04** Second Floor Demo Plan  
3/32"=1'-0"

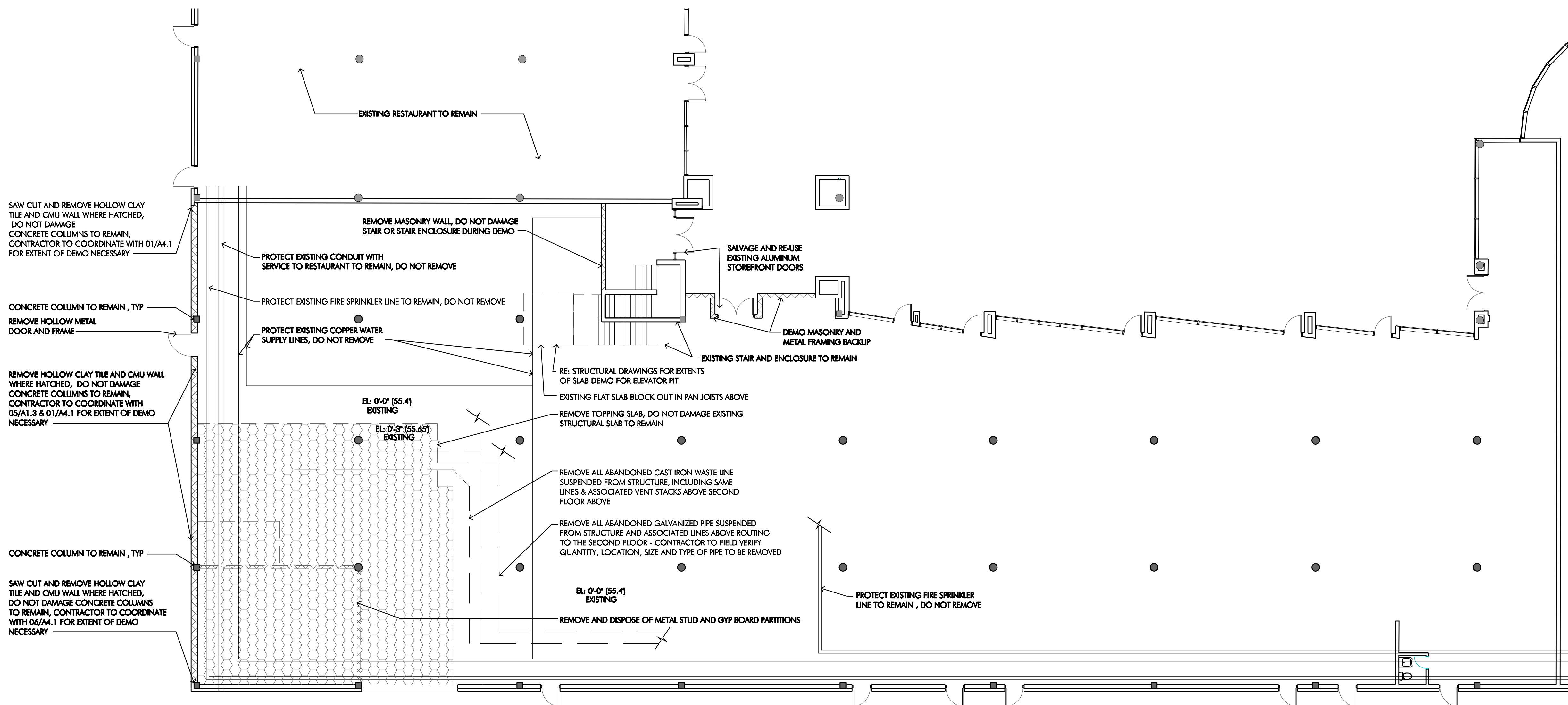

**01** First Floor Demo Plan  
3/32"=1'-0"